



8 St. Agathas Road, Coventry, CV2 4DX Offers Over £160,000

***** IDEAL INVESTMENT PURCHASE OR FIRST TIME BUYER HOME*****

Situated in the vibrant Stoke area of Coventry, this fabulous mid-terrace house on St. Agatha's Road presents an excellent opportunity for first-time buyers or savvy investors. The property boasts two spacious reception rooms, providing ample space for both relaxation and entertaining. The living room and dining room are well-proportioned, creating a warm and inviting atmosphere.

The heart of the home is undoubtedly the stunning refitted high gloss grey kitchen, which combines modern aesthetics with functionality. This stylish kitchen is perfect for those who enjoy cooking and entertaining. Additionally, the ground floor features a beautifully refitted shower room, enhancing the convenience of daily living.

Upstairs, you will find two generous double bedrooms, each offering a comfortable retreat. The property is in move-in condition, allowing you to settle in without the need for immediate renovations.

Outside, the home benefits from a small front garden and a rear garden, providing a pleasant outdoor space for relaxation or gardening. The location is particularly advantageous, being close to local amenities and the popular Ball Hill shopping area, ensuring that all your daily needs are within easy reach.

With no onward chain, this property is ready for you to make it your own. Don't miss the chance to view this delightful home that perfectly combines comfort, style, and convenience in a sought-after area of Coventry.

Living room

10'7 x 11'6 (3.23m x 3.51m)

Dining Room

10'9 x 14'5 (3.28m x 4.39m)



Kitchen

10'6 x 5'10 (3.20m x 1.78m)

Bathroom

5'10 x 7'4 (1.78m x 2.24m)

Bedroom one

10'7 x 11'4 (3.23m x 3.45m)



Bedroom Two

10'7 x 11'3 (3.23m x 3.43m)

Floor Plan

8 ST, AGATHAS

Approximate Gross Internal Area 674 sq ft / 62.61 sq m

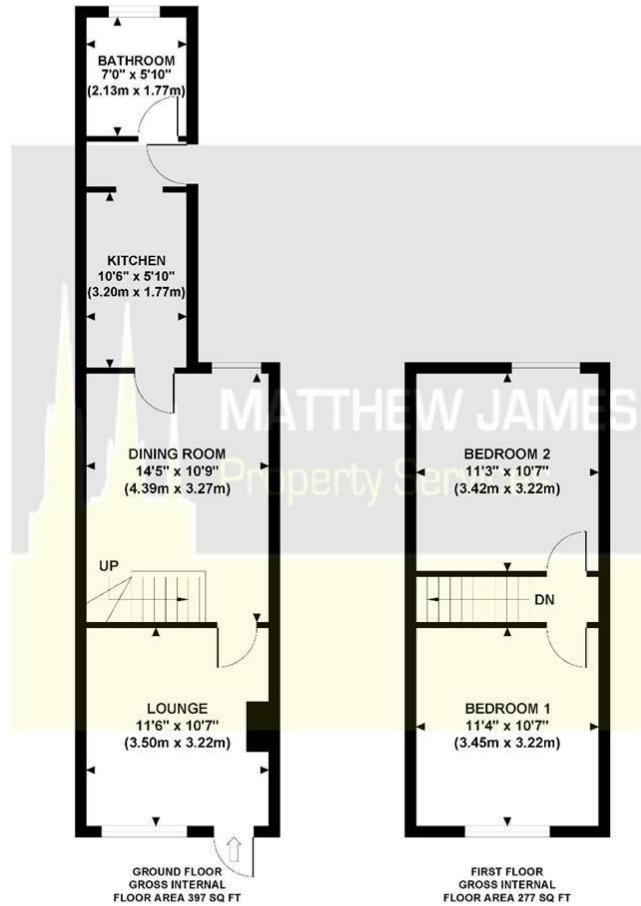

Although every attempt has been made to ensure accuracy, all measurements are approximate and no responsibility is taken for any error, omission, or mid-statement. This floor plan is for illustrative purposes only and not to scale. Measured in accordance to RICS standards.

Area Map

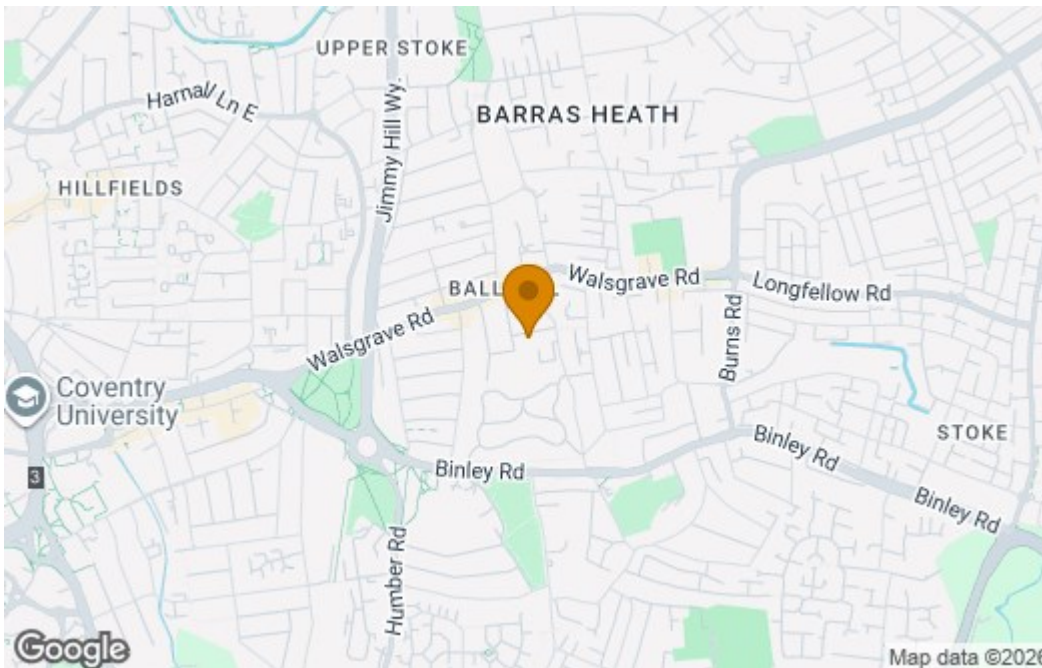

Energy Efficiency Graph

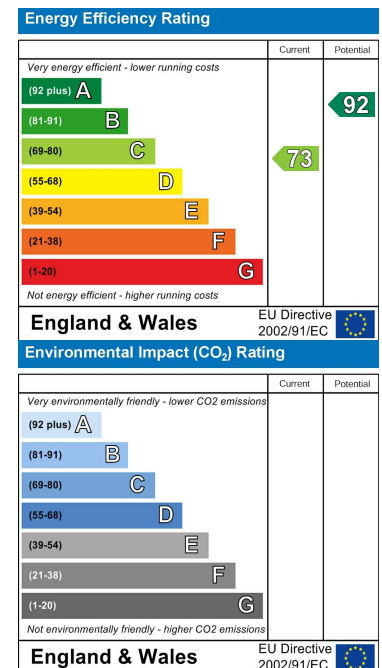

These particulars, whilst believed to be accurate are set out as a general outline only for guidance and do not constitute any part of an offer or contract. Intending purchasers should not rely on them as statements of representation of fact, but must satisfy themselves by inspection or otherwise as to their accuracy. No person in this firm's employment has the authority to make or give any representation or warranty in respect of the property.

CONTACT INFORMATION

24a Warwick Row, Coventry CV1 1EY

02477 170170

info@matthewjames.uk.com

www.matthewjames.uk.com

Facebook

Twitter